

DIMENSIONAL FEATURES

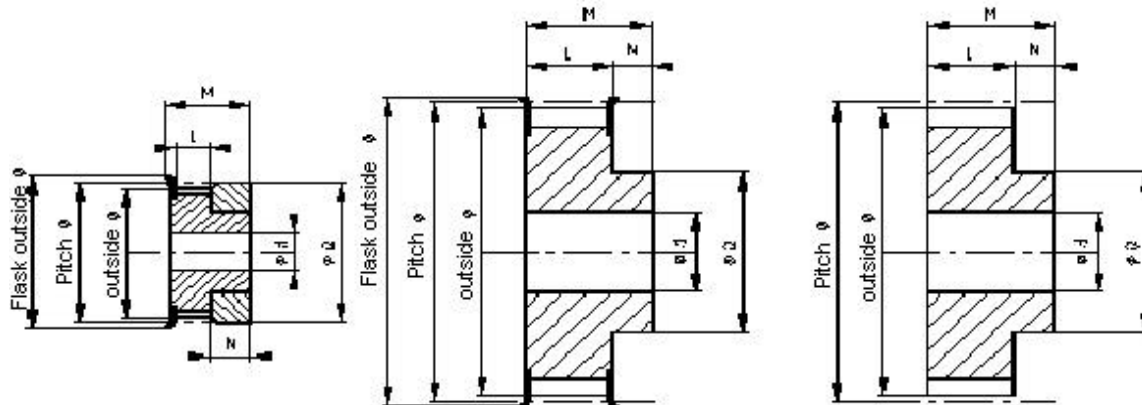

Type 1F

Type 1

Type 2

Designation

Total width (M)	Pitch	Nb. of teeth	flasked
-----------------	-------	--------------	---------

Pitch T2.5 (2.5 mm) for Timing Belt - Width 6 mm

	Pitch φ (outside φ)									
16T2.512F	9.55 (9.00)	1F	4	6	9	13	16	7	12	0.003
16T2.514F	11.14 (10.60)	1F	4	8	9	15	16	7	14	0.004
16T2.516F	12.73 (12.20)	1F	4	8	10	15	16	6	14	0.005
16T2.518F	14.32 (13.80)	1	4	6	10	17.5	16	6	10	0.006
16T2.520F	15.92 (15.40)	1	4	6	10	19.5	16	6	12	0.008
16T2.522F	17.51 (17.00)	1	4	6	10	23	16	6	12	0.010
16T2.524F	19.10 (18.55)	1	4	6	10	23	16	6	12	0.012
16T2.525F	19.89 (19.35)	1	4	8	10	23	16	6	14	0.013
16T2.526F	20.69 (20.15)	1	4	8	10	25	16	6	14	0.015
16T2.528F	22.28 (21.75)	1	4	8	10	25	16	6	14	0.016
16T2.530F	23.87 (23.35)	1	6	10	10	28	16	6	16	0.018
16T2.532F	25.48 (24.45)	1	6	10	10	32	16	6	16	0.020
16T2.536F	28.66 (28.10)	1	6	12	10	37	16	6	20	0.026
16T2.540F	31.83 (31.30)	1	6	12	10	38	16	6	22	0.032
16T2.544F	35.02 (34.50)	1	6	14	10	43	16	6	24	0.040
16T2.548	38.20 (37.70)	2	6	15	10		16	6	26	0.048
16T2.560	47.75 (47.25)	2	8	22	10		16	6	34	0.073

* with keying : Norm NFE 22175

Cast iron FGL 250, Protection by phosphatation or black paint.

COLMANT CUVELIER S.A.

rue Greuze - B.P. 529 - 59022 LILLE CEDEX - FRANCE

tél : (33) 03 20 67 79 01 - fax : (33) 03 20 67 79 79

